

Freestanding Charter School Facility 14,480±sf for LEASE

6659 E University Drive, Mesa

\$12/sf
MODIFIED GROSS



Beautiful facility located in Mesa on University Drive east of Power Road.

FEATURES:

- 11 Classrooms
- Library
- Teacher's lounge & general admin office
- Lunchroom with indoor/outdoor seating
- Two sets of restrooms
- Outdoor practice field
- Pick up/drop off zone
- Ample parking

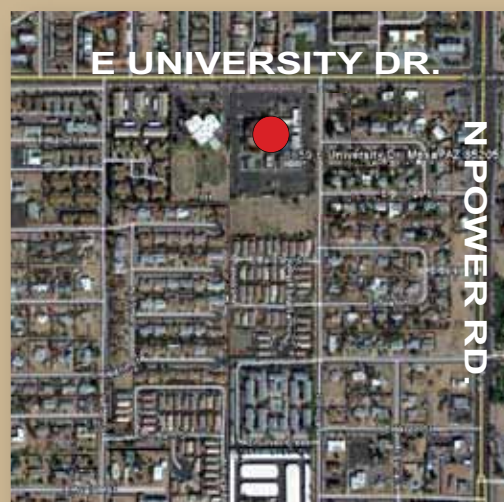

All information regarding property is from sources is deemed reliable, but no warranty is made to its accuracy, and no liability is to be imposed on the broker. The same is submitted to errors, omissions, change of price, rental or other conditions, prior to transaction.



John Quatrini, Associate Broker

JQ@shellcommercial.com

16410 north 91st street
suite 112
scottsdale, arizona 85260

480.443.3992
shellcommercial.com

Freestanding Charter School Facility

6659 E University Drive, Mesa



**CHURCH OF THE MASTER
CAMPUS MAP
6659 E University Drive
± 14,480 SF**

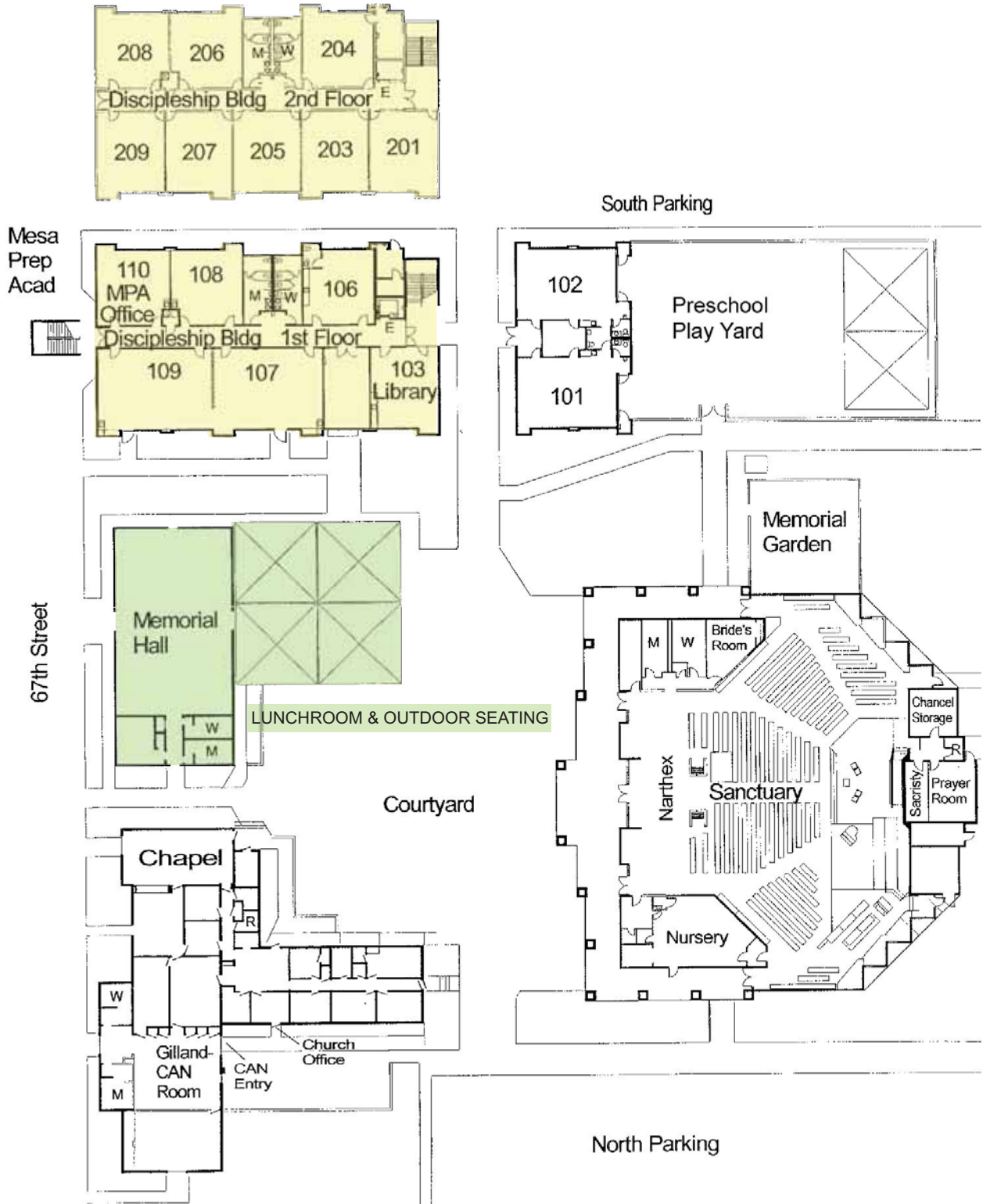

NOT TO SCALE

All information furnished regarding property for sale, rental or financing is from sources deemed reliable, but no warranty or representation is made to the accuracy thereof and same is submitted to errors, omissions, change of price, rental or other conditions, prior to sale, lease or financing or withdrawal without notice. No liability of any kind is to be imposed on the broker herein. This information has been secured from sources deemed reliable, however, we make no warranties as to its accuracy.