

Office/Showroom/Warehouse for **LEASE** ±22,000 sf

7995 E Paradise Lane (Facing Greenway-Hayden Loop) • Scottsdale Airpark

PRIME SCOTTSDALE AIRPARK LOCATION!



FEATURES:

- Spacious lobby, reception
- Executive office, 2 offices
- Showroom
- Break room, 2 restrooms
- Storage room
- Mezzanine
- Shop area, work room, finishing area, paint booth
- Loading dock
- Excellent visibility on Greenway-Hayden Loop!



For more information or to request a showing, call us at 480.443.3992



Randy Shell
Designated Broker
Mobile
480.694.4100
randy@shellcommercial.com

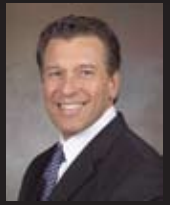

John Quatrini
Associate Broker
602.859.0506
jq@shellcommercial.com



Michelle Gardner
Sales/Leasing Agent
Mobile
480.266.8724
michelle@shellcommercial.com



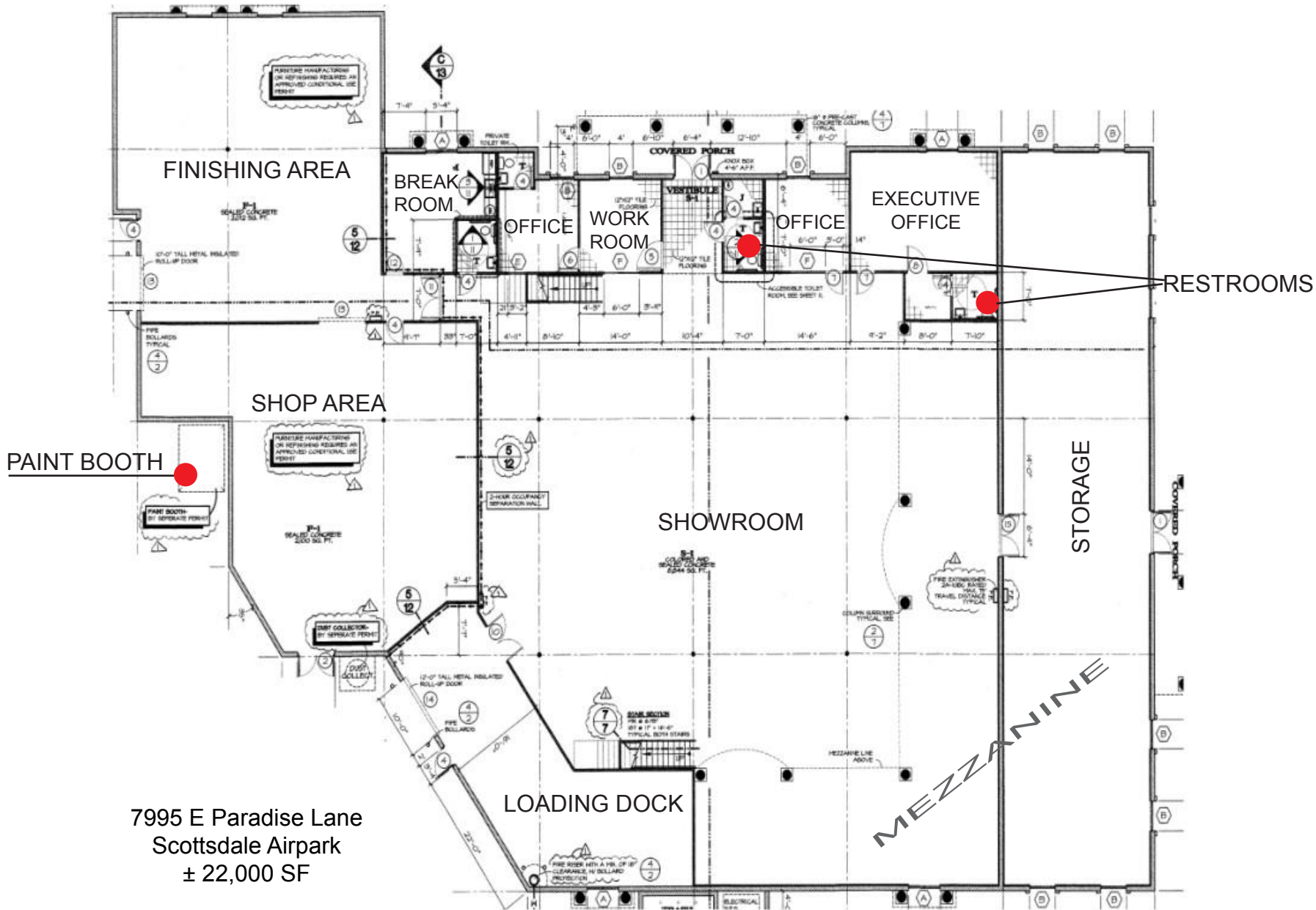

NOT TO SCALE

All information furnished regarding property for sale, rental or financing is from sources deemed reliable, but no warranty or representation is made to the accuracy thereof and same is submitted to errors, omissions, change of price, rental or other conditions, prior to sale, lease or financing or withdrawal without notice. No liability of any kind is to be imposed on the broker herein. This information has been secured from sources deemed reliable, however, we make no warranties as to its accuracy.